

PLANT SCHEDULE

CODE	QTY	BOTANICAL / COMMON NAME	CAL.	HT.	SPRD.	CONT.	COMMENTS
SHADE TREES							
GTH	1	Gleditsia triacanthos inermis 'Halka' / Halka Thornless Honey Locust	4'-4.5" cal.	15'-17'		B&B	Full Specimens, headed to 7'
ORNAMENTAL TREES							
LIT	4	Lagerstroemia indica 'Tuscarora' / Tuscarora Crape Myrtle	(1) @ 2" cal.	10'-12'		B&B	Heavy, Multi-stemmed specimens, 3-5 canes
SHRUBS							
CAK	18	Calamagrostis arundinacea 'Karl Foerster' / Feather Reed Grass	-	-	-	3 gal.	Full Plants, 2' O.C.
HAB	12	Hydrangea arborescens 'Balmactive' / Summer Crush Hydrangea	-	2'-2.5'	-	#7 cont.	Full Plants, 3' O.C.
HMS	8	Hydrangea macrophylla 'Endless Summer' / Endless Summer Hydrangea	-	2.5'-3'	-	#7 cont.	Full Plants, 3' O.C.
PH	13	Panicum virgatum 'Heavy Metal' / Heavy Metal Switch Grass	-	-	-	3 Gal.	Full Plants, 2' O.C.
PERENNIALS, GROUNDCOVERS, & GRASSES							
EPM	30	Echinacea purpurea 'Magnus' / Magnus Purple Coneflower	-	-	-	2 Gal.	Full Plants, 18" O.C.
LMB	673	Liriope muscari 'Big Blue' / Big Blue Lilyturf	-	-	-	1 Gal.	Full Plants, 12" O.C.
PAH	63	Pennisetum alopecuroides 'Hameln' / Hameln Dwarf Fountain Grass	-	-	-	2 Gal.	Full Plants, 18" O.C.
RFG	10	Rudbeckia fulgida 'Goldstrum' / Black-Eyed Susan	-	-	-	2 Gal.	Full Plants, 18" O.C.
RM	17	Rosa x 'Meiszieland' / White Drift Rose	-	18"-24"	18"-24"	#5 cont.	Full Plants, 2.5' O.C.
SM	26	Salvia nemorosa 'Mainacht' / Maynight Meadow Sage	-	-	-	2 Gal.	Full Plants, 18" O.C.

LIGHTING (XL)						
CODE	DESCRIPTION	MODEL	COLOR/ FINISH	MANUFACTURER	IMAGE	
XL-01	TREE UPLIGHT	1043 LED FLOOD LIGHT 1043-B-MF-30-F-MV-HS-R54 OR EQUAL	BLACK	VISTA PROFESSIONAL OUTDOOR LIGHTING WWW.VISTAPRO.COM		
XL-02	STRING LIGHTS	STRING LIGHT MODEL #: ETLS-MS-24-48-BK OR EQUAL CABLE MODEL #: LS-CABLE-500 FASTENERS: LS-LOCK-10 (AS NEEDED) TENSIONING TOOL: LS-TT (AS NEEDED)	BLACK	AMERICAN LIGHTING WWW.AMERICANLIGHTING.COM		
XL-03	STRING LIGHT BULB	PG40-E26-WW VOLTAGE: 120V WATTAGE: 1440W (MAX RUN) COLOR TEMP: 3000K OR EQUAL		AMERICAN LIGHTING WWW.AMERICANLIGHTING.COM		
XL-04	TRELLIS LIGHT	GR-5006-BSO-4.5-W-36 OR EQUAL	OLD BRASS	VISTA PROFESSIONAL OUTDOOR LIGHTING WWW.VISTAPRO.COM		
XL-05	BUILDING MOUNTED UPLIGHT	C165 SLICE-RGBW-E-SERIES-NARROW-EGM01+SPR EAD FOIL-14-4212RAL-9003 OR EQUAL	WHITE	EWO LIGHTING WWW.EWO.COM		
XL-06	BUILDING MOUNTED SCENCE	LLFH102-LE8-30K-BLK-F OR EQUAL	BLACK	LUMENCIA LIGHTING WWW.LUMENCIA.COM		
XL-07	BUILDING STRIP LIGHT	NEO3WW-RBGW(30K) DMX-WH-HO-15-CC@ xx'-CH1-N3WS-RC OR EQUAL	WHITE	OMNILIGHT WWW.OMNILIGHT.COM		

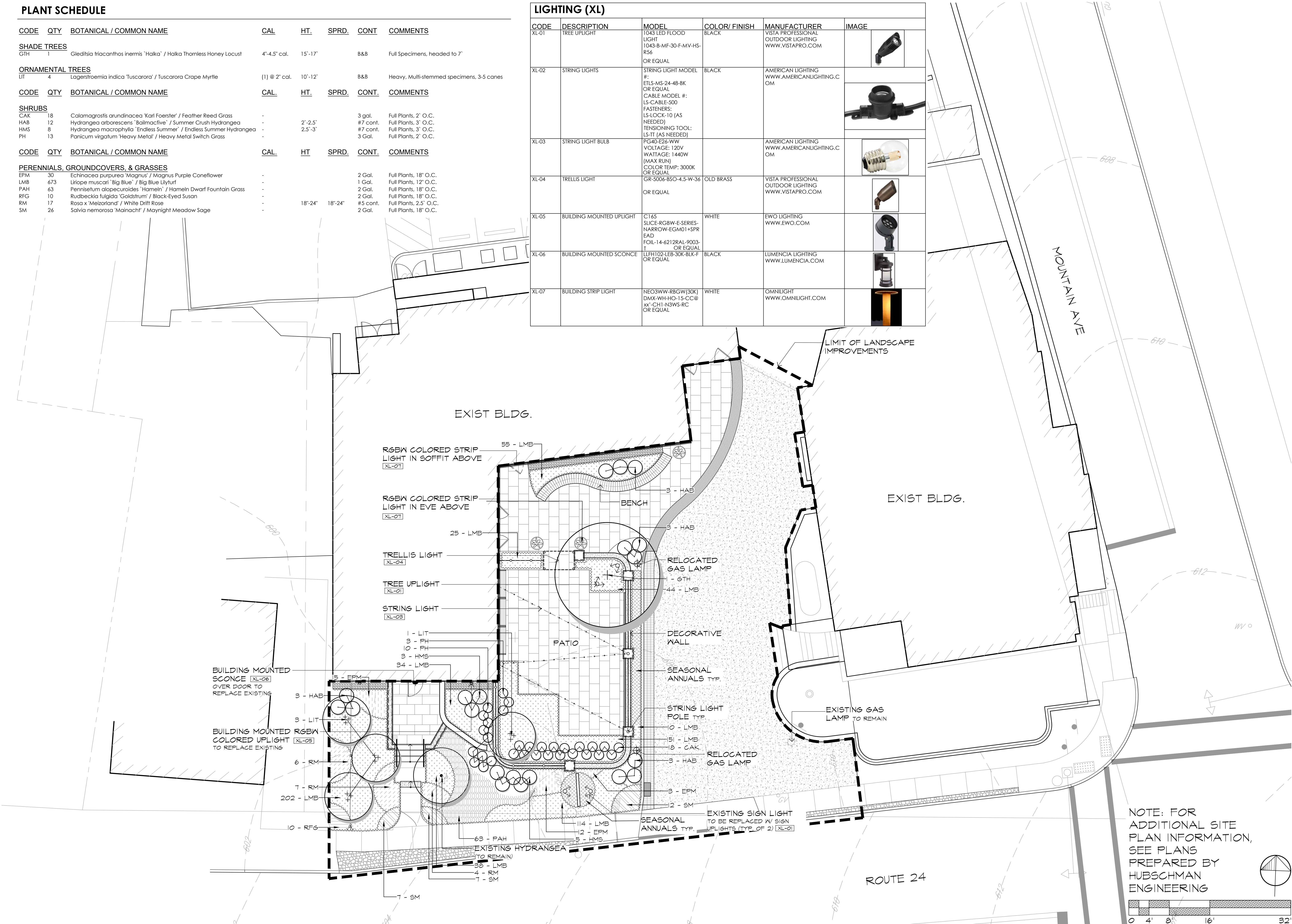

NOTE: FOR ADDITIONAL SITE PLAN INFORMATION, SEE PLANS PREPARED BY HUBSCHMAN ENGINEERING

